

1565 Chenault Street, Dallas, Texas 75228

July 29, 2022

Office of Hopkins County Judge  
PO BOX 288  
Sulphur Springs, Texas 75483

**Underground Parallel &/OR Crossing(s)  
Project PID 3404418**

Greetings,

Spectrum/Charter is requesting permission to construct and placement of underground conduit and fiber. This request is for proposed construction county road 4720 and county road 4786, which is located in Hopkins County, Texas.

Site location map and google plans are enclosed. The construction plans detail the proposed work.

If you have any questions, please contact me at any time.

Sincerely,

*Jason Kennedy*

Project Coordinator  
[Jason.kennedy@charter.com](mailto:Jason.kennedy@charter.com)  
Phone 903-513-2738

Submitted by:

Dayna LaPoma / Jessie Hatley  
Project Coordinator / RDOF Coordinator  
[Dayna.lapoma@dfw-telecom.com](mailto:Dayna.lapoma@dfw-telecom.com)  
[Jessie.hatley@dfw-telecom.com](mailto:Jessie.hatley@dfw-telecom.com)

Enclosures

County Approval Section:

Approved: \_\_\_\_\_

Denied: \_\_\_\_\_

Authorized Signature: \_\_\_\_\_

Date: \_\_\_\_\_

8-8-22



Hopkins County

NOTE  
CONTRACTOR IS RESPONSIBLE TO MAINTAIN TRAFFIC CONTROL DEVICES FOR STREETS AND HIGHWAYS AS SET FORTH IN THE TEXAS MANUAL ON UNIFORM TRAFFIC CONTROL DEVICES FOR STREETS AND HIGHWAYS

Hopkins County Notes: Bore only no trenching and the conduit placement should be the backside of ditch away from the county road when running parallel to the CR

Project consist of approximately 1,549' underground



**PID 3404418**  
Underground on CR 4720 and CR 4786

**GENERAL CONSTRUCTION NOTES**

1. ALL CONSTRUCTION WORK WITHIN THE PUBLIC RIGHT-OF-WAY SHALL BE DONE IN ACCORDANCE WITH THE ORDINANCES AND REGULATIONS OF THE MUNICIPALITY IN WHICH THE WORK IS TO BE PERFORMED.
2. EXISTING UTILITY LOCATIONS SHOWN ARE TAKEN FROM AVAILABLE RECORDS, AND MAY NOT BE ALL INCLUSIVE. THE CONTRACTOR SHALL VERIFY THE LOCATION AND DEPTH OF ALL UTILITIES PRIOR TO CONSTRUCTION. THE CONTRACTOR SHALL BE RESPONSIBLE FOR OBTAINING ALL NECESSARY PERMITS AND APPROVALS FROM THE MUNICIPALITY AND LOCAL AGENCIES. THE CONTRACTOR SHALL BE RESPONSIBLE FOR OBTAINING ALL NECESSARY PERMITS AND APPROVALS FROM THE MUNICIPALITY AND LOCAL AGENCIES. THE CONTRACTOR SHALL BE RESPONSIBLE FOR OBTAINING ALL NECESSARY PERMITS AND APPROVALS FROM THE MUNICIPALITY AND LOCAL AGENCIES.
3. THE CONTRACTOR SHALL BE RESPONSIBLE FOR CONDUCTING SURVEYS AND RECONSTRUCTION WORK IN ACCORDANCE WITH THE MUNICIPALITY'S REQUIREMENTS. THE CONTRACTOR SHALL BE RESPONSIBLE FOR OBTAINING ALL NECESSARY PERMITS AND APPROVALS FROM THE MUNICIPALITY AND LOCAL AGENCIES.
4. IT SHALL BE THE RESPONSIBILITY OF THE CONSTRUCTION CONTRACTOR TO: A) PREVENT DAMAGE TO PRIVATE AND PUBLIC PROPERTY; B) RESTORE ALL AREAS EFFECTED BY THE CONSTRUCTION TO ORIGINAL OR BETTER CONDITION.
5. INTERFERING AND TRAFFIC CONTROL SHALL BE THE RESPONSIBILITY OF THE CONSTRUCTION CONTRACTOR AND SHALL CONFORM TO THE TEXAS MANUAL ON UNIFORM TRAFFIC CONTROL DEVICES. TRAFFIC FLOW AND ACCESS SHALL BE MAINTAINED DURING ALL PHASES OF CONSTRUCTION. THE CONSTRUCTION CONTRACTOR IS RESPONSIBLE FOR MAINTAINING ALL TRAFFIC DEVICES FOR WORK ON THE PROJECT. THE WORK SITE SHALL BE SURROUNDED BY AND BARRICADED AT NIGHT.
6. THE CONSTRUCTION CONTRACTOR SHALL ABIDE BY ALL APPLICABLE FEDERAL, STATE AND LOCAL LAWS COVERING EXCAVATION. THE CONSTRUCTION CONTRACTOR SHALL PROVIDE ALL NECESSARY SAFETY SYSTEMS THAT COMPLY WITH ALL APPLICABLE FEDERAL, STATE AND LOCAL LAWS. THE CONSTRUCTION CONTRACTOR SHALL BE SOLELY RESPONSIBLE FOR ALL ASPECTS OF WORK RELATED TO EXCAVATION.
7. ALL CONCRETE USED IN ANY ROADWAY SHALL BE IN COMPLIANCE WITH THE SPECIFIED CLASSES OF CONCRETE IN THE STANDARD SPECIFICATIONS. B. PORTLAND CEMENT CONCRETE (PAVEMENT) AND 7.4.5 "QUALITY OF CONCRETE CONSTRUCTION" - 2004. ALL OTHER CONCRETE SHALL BE CLASS A CONCRETE.
8. ALL REINFORCING STEEL AND DOWEL BARS IN PAVEMENT SHALL BE SUPPORTED AND MAINTAINED AT THE CORRECT CLEARANCES BY THE USE OF BAR CHAIRS OR OTHER APPROVED SUPPORT.
9. ALL CONDUIT MUST BE PLACED WITH A MINIMUM 42" OF COVER, UNLESS OTHERWISE SPECIFIED.
10. ALL BACKFILLING WILL BE MECHANICALLY TAMPED IN LIFTS TO A DENSITY OF 90% PROCTOR. THE REQUIRED DENSITY WILL BE OBTAINED BY USING TAMPER, RAMMERS OR ROLLING EQUIPMENT. LIFTS MAY VARY ACCORDING TO DENSITY. ALL MATERIAL USED TO OBTAIN THE REQUIRED DENSITY SHALL BE THE SAME TYPE MATERIAL THAT WAS USED FOR BACKFILL.

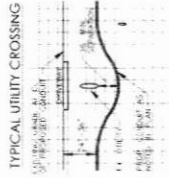

UNDERGROUND CONDUIT 1-2" HDPE

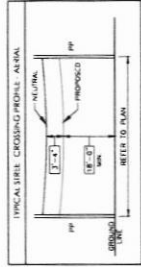

PREPARED BY: DFW TELECOM, INC



1565 Chenault Street, Dallas, Texas 75228

July 29, 2022

Office of Hopkins County Judge  
PO BOX 288  
Sulphur Springs, Texas 75483

**Underground Parallel &/OR Crossing(s)  
Project PID 3404418**

Greetings,

Spectrum/Charter is requesting permission to construct and placement of underground conduit and fiber. This request is for proposed construction county road 4724, which is located in Hopkins County, Texas.

Site location map and google plans are enclosed. The construction plans detail the proposed work.

If you have any questions, please contact me at any time.

Sincerely,

*Jason Kennedy*

Project Coordinator  
[Jason.kennedy@charter.com](mailto:Jason.kennedy@charter.com)  
Phone 903-513-2738

Submitted by:

Dayna LaPoma / Jessie Hatley  
Project Coordinator / RDOF Coordinator  
[Dayna.lapoma@dfw-telecom.com](mailto:Dayna.lapoma@dfw-telecom.com)  
[Jessie.hatley@dfw-telecom.com](mailto:Jessie.hatley@dfw-telecom.com)

Enclosures

---

County Approval Section:

Approved: \_\_\_\_\_

Denied: \_\_\_\_\_

Authorized Signature: \_\_\_\_\_

Date: \_\_\_\_\_

8-8-22



Hopkins County

**NOTE**  
CONTRACTOR IS RESPONSIBLE TO MAINTAIN TRAFFIC CONTROL DEVICES ON UNIFORM TRAFFIC CONTROL DEVICES FOR STREETS AND HIGHWAYS

Hopkins County Notes: Bore only no trenching and the conduit placement should be the backside of ditch away from the county road when running parallel to the CR

Project consist of approximately 3,887' underground

**GENERAL CONSTRUCTION NOTES**

1. ALL CONSTRUCTION WORK WITHIN THE PUBLIC RIGHT-OF-WAY SHALL BE DONE IN ACCORDANCE WITH THE ORDINANCES AND REGULATIONS OF THE MUNICIPALITY IN WHICH THE WORK IS TO BE PERFORMED.
2. EXISTING UTILITY LOCATIONS SHOWN ARE TAKEN FROM AVAILABLE RECORDS AND MAY NOT BE ALL INCLUSIVE. THE CONTRACTOR SHALL VERIFY THE LOCATION OF EACH PARTICULAR UTILITY. THE CONSTRUCTION CONTRACTOR SHALL BE RESPONSIBLE FOR THE LOCATION OF ALL UTILITIES AND THE PROTECTION OF ALL EXISTING UTILITIES WHETHER SHOWN OR NOT SHOWN ON THE PLANS. THE CONTRACTOR SHALL BE RESPONSIBLE FOR VERIFYING THE LOCATION OF ALL UTILITIES DAMAGED AS A DIRECT RESULT OF THE CONSTRUCTION ACTIVITIES WHETHER THE FACILITY IS SHOWN ON THE PLANS OR NOT.
3. THE CONSTRUCTION CONTRACTOR SHALL BE RESPONSIBLE FOR OBTAINING ALL NECESSARIES WITHIN THE MUNICIPALITY AND THE UTILITY COMPANIES AT LEAST TWO WORKING DAYS PRIOR TO THE COMMENCEMENT OF WORK. CALL BEFORE YOU DIG.
4. IT SHALL BE THE RESPONSIBILITY OF THE CONSTRUCTION CONTRACTOR TO: A) PREVENT DAMAGE TO PRIVATE AND PUBLIC PROPERTY; B) RESTORE ALL AREAS AFFECTED BY THE CONSTRUCTION TO ORIGINAL OR BETTER CONDITION.
5. UNBARRICADING AND TRAFFIC CONTROL SHALL BE THE RESPONSIBILITY OF THE CONSTRUCTION CONTRACTOR AND SHALL CONFORM TO THE TEXAS MANUAL ON UNIFORM TRAFFIC CONTROL DEVICES. TRAFFIC FLOW AND ACCESS SHALL BE MAINTAINED DURING ALL PHASES OF CONSTRUCTION. THE CONSTRUCTION CONTRACTOR SHALL BE RESPONSIBLE FOR THE LOCATION OF ALL PHASES OF CONSTRUCTION. THE CONSTRUCTION CONTRACTOR SHALL BE RESPONSIBLE FOR THE LOCATION OF ALL PHASES OF CONSTRUCTION. THE CONSTRUCTION CONTRACTOR SHALL BE RESPONSIBLE FOR THE LOCATION OF ALL PHASES OF CONSTRUCTION.
6. THE CONSTRUCTION CONTRACTOR SHALL ABIDE BY ALL APPLICABLE FEDERAL, STATE AND LOCAL LAWS GOVERNING EXCAVATION, CONCRETE, AND OTHER RELATED ACTIVITIES. THE CONSTRUCTION CONTRACTOR SHALL BE SOLELY RESPONSIBLE FOR ALL ASPECTS OF WORK RELATED TO EXCAVATION.
7. ALL CONCRETE USED IN ANY ROADWAY SHALL BE IN COMPLIANCE WITH THE SPECIFIED CLASSES OF CONCRETE IN THE MANUAL ON UNIFORM TRAFFIC CONTROL DEVICES. THE CONSTRUCTION CONTRACTOR SHALL BE RESPONSIBLE FOR THE LOCATION OF ALL PHASES OF CONSTRUCTION. THE CONSTRUCTION CONTRACTOR SHALL BE RESPONSIBLE FOR THE LOCATION OF ALL PHASES OF CONSTRUCTION. THE CONSTRUCTION CONTRACTOR SHALL BE RESPONSIBLE FOR THE LOCATION OF ALL PHASES OF CONSTRUCTION.
8. ALL REINFORCING STEEL AND DOWEL BARS IN PAVEMENT SHALL BE SUPPORTED AND MAINTAINED AT THE CORRECT CLEARANCES BY THE USE OF DIM CHAIRS OR OTHER APPROVED SUPPORT.
9. ALL CONDUIT MUST BE PLACED WITH A MINIMUM 4" OF COVER UNLESS OTHERWISE SPECIFIED.
10. ALL REINFORCING STEEL AND DOWEL BARS IN PAVEMENT SHALL BE SUPPORTED AND MAINTAINED AT THE CORRECT CLEARANCES BY THE USE OF DIM CHAIRS OR OTHER APPROVED SUPPORT.
11. ALL REINFORCING STEEL AND DOWEL BARS IN PAVEMENT SHALL BE SUPPORTED AND MAINTAINED AT THE CORRECT CLEARANCES BY THE USE OF DIM CHAIRS OR OTHER APPROVED SUPPORT.
12. ALL REINFORCING STEEL AND DOWEL BARS IN PAVEMENT SHALL BE SUPPORTED AND MAINTAINED AT THE CORRECT CLEARANCES BY THE USE OF DIM CHAIRS OR OTHER APPROVED SUPPORT.
13. ALL REINFORCING STEEL AND DOWEL BARS IN PAVEMENT SHALL BE SUPPORTED AND MAINTAINED AT THE CORRECT CLEARANCES BY THE USE OF DIM CHAIRS OR OTHER APPROVED SUPPORT.
14. ALL REINFORCING STEEL AND DOWEL BARS IN PAVEMENT SHALL BE SUPPORTED AND MAINTAINED AT THE CORRECT CLEARANCES BY THE USE OF DIM CHAIRS OR OTHER APPROVED SUPPORT.
15. ALL REINFORCING STEEL AND DOWEL BARS IN PAVEMENT SHALL BE SUPPORTED AND MAINTAINED AT THE CORRECT CLEARANCES BY THE USE OF DIM CHAIRS OR OTHER APPROVED SUPPORT.



**PID 3404418**  
Underground on CR 4724

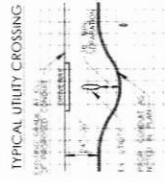

UNDERGROUND CONDUIT 1-2" HDPE

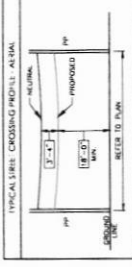



Hopkins County

**NOTE**  
CONTRACTOR IS RESPONSIBLE TO MAINTAIN TRAFFIC CONTROL AS SET FORTH IN THE TEXAS MANUAL ON UNIFORM TRAFFIC CONTROL DEVICES FOR STREETS AND HIGHWAYS

Hopkins County Notes: Bore only no trenching and the conduit placement should be the backside of ditch away from the county road when running parallel to the CR

Project consist of approximately 5,256' underground

**GENERAL CONSTRUCTION NOTES**

1. ALL CONSTRUCTION WORK WITHIN THE PUBLIC RIGHT-OF-WAY SHALL BE DONE IN ACCORDANCE WITH THE ORDINANCES AND REGULATIONS OF THE MUNICIPALITY IN WHICH THE WORK IS TO BE PERFORMED.
2. EXISTING UTILITY LOCATIONS SHOWN ARE TAKEN FROM AVAILABLE RECORDS AND MAY NOT BE ALL INCLUSIVE. UTILITY LOCATIONS ARE GENERALLY SCHEMATIC IN NATURE AND MAY NOT ACCURATELY REFLECT THE SIZE AND LOCATION OF EACH PARTICULAR UTILITY. THE CONSTRUCTION CONTRACTOR SHALL ASSUME RESPONSIBILITY FOR ACTUAL LINE LOCATED IN THE FIELD AND THE PROTECTION OF ALL EXISTING FACILITIES WHETHER SHOWN OR NOT. THE CONSTRUCTION CONTRACTOR SHALL ALSO ASSUME RESPONSIBILITY FOR REPAIRS TO ANY EXISTING FACILITY DAMAGED AS A DIRECT RESULT OF THE CONSTRUCTION ACTIVITIES WHETHER THE FACILITY IS SHOWN ON THE DRAWINGS OR NOT.
3. THE CONSTRUCTION CONTRACTOR SHALL BE RESPONSIBLE FOR CONTACTING ALL DEPARTMENTS WITHIN THE MUNICIPALITY AND THE UTILITY COMPANIES AT LEAST TWO WORKING DAYS PRIOR TO THE COMMENCEMENT OF WORK.  
CALL BEFORE YOU DIG  
811  
IT'S THE LAW
4. IT SHALL BE THE RESPONSIBILITY OF THE CONSTRUCTION CONTRACTOR TO: A) PREVENT DAMAGE TO PRIVATE AND PUBLIC PROPERTY; B) RESTORE ALL AREAS EFFECTED BY THE CONSTRUCTION TO ORIGINAL OR BETTER CONDITION.
5. BARRICADE AND TRAFFIC CONTROL SHALL BE THE RESPONSIBILITY OF THE CONSTRUCTION CONTRACTOR AND SHALL CONFORM TO THE TEXAS MANUAL ON UNIFORM TRAFFIC CONTROL DEVICES' TRAFFIC FLOW AND ACCESS. SHALL BE MAINTAINED DURING ALL PHASES OF CONSTRUCTION. THE CONSTRUCTION CONTRACTOR IS RESPONSIBLE FOR PROVIDING TRAFFIC SAFETY MEASURES FOR WORK ON THE PROJECT. THE WORK SITE SHALL BE SUITABLY LIT AND BARRICADED AT NIGHT.
6. THE CONSTRUCTION CONTRACTOR SHALL ABIDE BY ALL APPLICABLE FEDERAL, STATE AND LOCAL LAWS GOVERNING EXCAVATION. THE CONSTRUCTION CONTRACTOR SHALL PROVIDE ALL TRENCH SAFETY SYSTEMS THAT COMPLY WITH ALL LAWS GOVERNING EXCAVATION. THE CONSTRUCTION CONTRACTOR SHALL BE SOLELY RESPONSIBLE FOR ALL ASPECTS OF WORK RELATED TO EXCAVATION.
7. ALL CONCRETE USED IN ANY ROADWAY SHALL BE IN COMPLIANCE WITH THE SPECIFIED CLASSES OF CONCRETE IN THE STANDARD SPECIFICATIONS 5.8 "PORTLAND CEMENT CONCRETE PAVEMENT" AND 7.4.5 "QUALITY OF CONCRETE" AS AMENDED BY THE ADDENDUM TO THE NORTH CENTRAL TEXAS STANDARD SPECIFICATIONS FOR PUBLIC WORKS CONSTRUCTION - 2004. ALL OTHER CONCRETE SHALL BE CLASS A CONCRETE.
8. ALL REINFORCING STEEL AND DOWEL BARS IN PAVEMENT SHALL BE SUPPORTED AND MAINTAINED AT THE CORRECT CLEARANCES BY THE USE OF BAR CHAINS OR OTHER APPROVED SUPPORT.
9. ALL CONDUIT MUST BE PLACED WITH A MINIMUM 42" OF COVER, UNLESS OTHERWISE SPECIFIED.
10. ALL BACKFILL WILL BE MECHANICALLY TAMPED IN LIFTS TO A DENSITY OF 95% PROCTOR. THE REQUIRED DENSITY WILL BE OBTAINED BY USING TAMPERS, RAMMERS OR ROLLING EQUIPMENT. LIFTS MAY VARY ACCORDING TO THE TYPE OF EQUIPMENT USED TO OBTAIN THE REQUIRED DENSITY. SAND AND DEBRIS FREE MATERIAL WILL BE USED FOR BACKFILL.

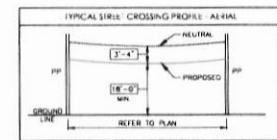
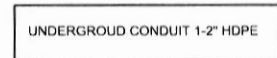
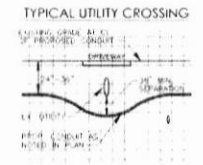

PREPARED BY: DFW TELECOM, INC



1565 Chenault Street, Dallas, Texas 75228

July 29, 2022

Office of Hopkins County Judge  
PO BOX 288  
Sulphur Springs, Texas 75483

**Underground Parallel &/OR Crossing(s)  
Project PID 3404418**

Greetings,

Spectrum/Charter is requesting permission to construct and placement of underground conduit and fiber. This request is for proposed construction county road 4725, which is located in Hopkins County, Texas.

Site location map and google plans are enclosed. The construction plans detail the proposed work.

If you have any questions, please contact me at any time.

Sincerely,

*Jason Kennedy*

Project Coordinator  
[Jason.kennedy@charter.com](mailto:Jason.kennedy@charter.com)  
Phone 903-513-2738

Submitted by:

Dayna LaPoma / Jessie Hatley  
Project Coordinator / RDOF Coordinator  
[Dayna.lapoma@dfw-telecom.com](mailto:Dayna.lapoma@dfw-telecom.com)  
[Jessie.hatley@dfw-telecom.com](mailto:Jessie.hatley@dfw-telecom.com)

Enclosures

---

County Approval Section:

Approved: \_\_\_\_\_

Denied: \_\_\_\_\_

Authorized Signature: \_\_\_\_\_

Date: \_\_\_\_\_

8-8-22



Hopkins County

CONTRACTOR IS RESPONSIBLE FOR OBTAINING ALL NECESSARY TRAFFIC CONTROL DEVICES AS SET FORTH IN THE TEXAS MANUAL ON UNIFORM TRAFFIC CONTROL DEVICES FOR STREETS AND HIGHWAYS

Hopkins County Notes: Bore only no trenching and the conduit placement should be the backside of ditch away from the county road when running parallel to the CR

Project consist of approximately: 3,038' underground

**GENERAL CONSTRUCTION NOTES**

1. ALL CONSTRUCTION WORK WITHIN THE PUBLIC RIGHT-OF-WAY SHALL BE DONE IN ACCORDANCE WITH THE ORDINANCES AND REGULATIONS OF THE MUNICIPALITY IN WHICH THE WORK IS TO BE PERFORMED.
2. THE CONSTRUCTION CONTRACTOR SHALL BE RESPONSIBLE FOR OBTAINING ALL NECESSARY TRAFFIC CONTROL DEVICES AS SET FORTH IN THE TEXAS MANUAL ON UNIFORM TRAFFIC CONTROL DEVICES FOR STREETS AND HIGHWAYS.
3. THE CONSTRUCTION CONTRACTOR SHALL BE RESPONSIBLE FOR CONTACTING ALL DEPARTMENTS WITHIN THE MUNICIPALITY AND THE UTILITY COMPANIES AT LEAST TWO WORKING DAYS PRIOR TO THE COMMENCEMENT OF WORK.
4. IT SHALL BE THE RESPONSIBILITY OF THE CONSTRUCTION CONTRACTOR TO:
  - a) PREPARE A PLAN TO IMPROVE AND RESTORE ALL AREAS AFFECTED BY THE CONSTRUCTION TO ORIGINAL OR BETTER CONDITION.
  - b) MAINTAIN ALL EXISTING UTILITIES AND STRUCTURES.
  - c) MAINTAIN ALL EXISTING TRAFFIC CONTROL DEVICES AND STRUCTURES.
  - d) MAINTAIN ALL EXISTING TRAFFIC CONTROL DEVICES AND STRUCTURES.
  - e) MAINTAIN ALL EXISTING TRAFFIC CONTROL DEVICES AND STRUCTURES.
5. BARRICADING AND TRAFFIC CONTROL SHALL BE THE RESPONSIBILITY OF THE CONSTRUCTION CONTRACTOR AND SHALL CONFORM TO THE TEXAS MANUAL ON UNIFORM TRAFFIC CONTROL DEVICES. TRAFFIC FLOW AND ACCESS FOR PROUDING TRAFFIC SAFETY MEASURES FOR WORK ON THE PROJECT THE WORK SITE SHALL BE SUITABLE AND BARRICADED AT NIGHT.
6. ALL MATERIALS SHALL BE STORED IN A SECURE MANNER AND SHALL BE KEPT SEPARATE FROM ALL OTHER MATERIALS. THE CONSTRUCTION CONTRACTOR SHALL BE RESPONSIBLE FOR OBTAINING ALL NECESSARY TRAFFIC CONTROL DEVICES AS SET FORTH IN THE TEXAS MANUAL ON UNIFORM TRAFFIC CONTROL DEVICES FOR STREETS AND HIGHWAYS.
7. ALL WORK SHALL BE DONE IN ACCORDANCE WITH THE STANDARD SPECIFICATIONS FOR PUBLIC WORKS AS AMENDED BY THE ADDENDUM TO THE NORTH-CENTRAL TEXAS STANDARD SPECIFICATIONS FOR PUBLIC WORKS. ALL CONDUIT SHALL BE PLACED WITH A MINIMUM 42" OF COVER, UNLESS OTHERWISE SPECIFIED.
8. ALL CONDUIT SHALL BE PLACED WITH A MINIMUM 42" OF COVER, UNLESS OTHERWISE SPECIFIED.
9. ALL CONDUIT MUST BE PLACED WITH A MINIMUM 42" OF COVER, UNLESS OTHERWISE SPECIFIED.
10. ALL CONDUIT SHALL BE PLACED WITH A MINIMUM 42" OF COVER, UNLESS OTHERWISE SPECIFIED.



**PID 3404418**  
Underground on CR 4725

**TYPICAL UTILITY CROSSING**

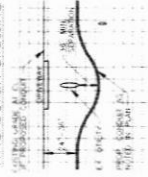

UNDERGROUND CONDUIT 12" HDPE

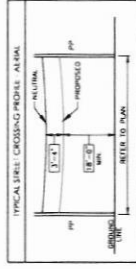



1565 Chenault Street, Dallas, Texas 75228

July 29, 2022

Office of Hopkins County Judge  
PO BOX 288  
Sulphur Springs, Texas 75483

**Underground Parallel &/OR Crossing(s)  
Project PID 3404418**

Greetings,

Spectrum/Charter is requesting permission to construct and placement of underground conduit and fiber. This request is for proposed construction county road 4734, which is located in Hopkins County, Texas.

Site location map and google plans are enclosed. The construction plans detail the proposed work.

If you have any questions, please contact me at any time.

Sincerely,

*Jason Kennedy*

Project Coordinator  
[Jason.kennedy@charter.com](mailto:Jason.kennedy@charter.com)  
Phone 903-513-2738

Submitted by:

Dayna LaPoma / Jessie Hatley  
Project Coordinator / RDOF Coordinator  
[Dayna.lapoma@dfw-telecom.com](mailto:Dayna.lapoma@dfw-telecom.com)  
[Jessie.hatley@dfw-telecom.com](mailto:Jessie.hatley@dfw-telecom.com)

Enclosures

---

County Approval Section:

Approved: \_\_\_\_\_

Denied: \_\_\_\_\_

Authorized Signature: 

Date: 8-8-22





Hopkins County

**NOTE**  
 CONTRACTOR IS RESPONSIBLE TO MAINTAIN TRAFFIC CONTROL AS SET FORTH IN THE TEXAS MANUAL ON UNIFORM TRAFFIC CONTROL DEVICES FOR STREETS AND HIGHWAYS

Project consist of approximately:  
 3,887' underground

Hopkins County Notes: Bore only no trenching and the conduit placement should be the backside of ditch away from the county road when running parallel to the CR

**GENERAL CONSTRUCTION NOTES**

1. ALL CONSTRUCTION WORK WITHIN THE PUBLIC RIGHT-OF-WAY SHALL BE DONE IN ACCORDANCE WITH THE ORDINANCES AND REGULATIONS OF THE MUNICIPALITY IN WHICH THE WORK IS TO BE PERFORMED.
2. EXISTING UTILITY LOCATIONS SHOWN ARE TAKEN FROM AVAILABLE RECORDS AND MAY NOT BE ALL. INCLUDE UTILITY LOCATIONS ARE GENERALLY SCHEMATIC IN NATURE AND MAY NOT ACCURATELY REFLECT THE SIZE AND LOCATION OF EACH PARTICULAR UTILITY. THE CONSTRUCTION CONTRACTOR SHALL ASSUME RESPONSIBILITY FOR ACTUAL LINE LOCATED IN THE FIELD AND THE PROTECTION OF ALL EXISTING FACILITIES WHETHER SHOWN OR NOT. THE CONSTRUCTION CONTRACTOR SHALL ALSO ASSUME RESPONSIBILITY FOR REPAIRS TO ANY EXISTING FACILITY DAMAGED AS A DIRECT RESULT OF THE CONSTRUCTION ACTIVITIES WHETHER THE FACILITY IS SHOWN ON THE DRAWINGS OR NOT.
3. THE CONSTRUCTION CONTRACTOR SHALL BE RESPONSIBLE FOR CONTACTING ALL DEPARTMENTS WITHIN THE MUNICIPALITY AND THE UTILITY COMPANIES AT LEAST TWO WORKING DAYS PRIOR TO THE COMMENCEMENT OF WORK.  
 CALL BEFORE YOU DIG  
 811  
 IT'S THE LAW
4. IF SHALL BE THE RESPONSIBILITY OF THE CONSTRUCTION CONTRACTOR TO: a) PREVENT DAMAGE TO PRIVATE AND PUBLIC PROPERTY b) RESTORE ALL AREAS EFFECTED BY THE CONSTRUCTION TO ORIGINAL OR BETTER CONDITION
5. BARRICADING AND TRAFFIC CONTROL SHALL BE THE RESPONSIBILITY OF THE CONSTRUCTION CONTRACTOR AND SHALL CONFORM TO THE "TEXAS MANUAL ON UNIFORM TRAFFIC CONTROL DEVICES". TRAFFIC FLOW AND ACCESS SHALL BE MAINTAINED DURING ALL PHASES OF CONSTRUCTION. THE CONSTRUCTION CONTRACTOR IS RESPONSIBLE FOR PROVIDING TRAFFIC SAFETY MEASURES FOR WORK ON THE PROJECT. THE WORK SITE SHALL BE SUITABLY LIT AND BARRICADED AT NIGHT.
6. THE CONSTRUCTION CONTRACTOR SHALL ABIDE BY ALL APPLICABLE FEDERAL, STATE AND LOCAL LAWS GOVERNING EXCAVATION. THE CONSTRUCTION CONTRACTOR SHALL PROVIDE ALL TRENCH SAFETY SYSTEMS THAT COMPLY WITH ALL LAWS GOVERNING EXCAVATION. THE CONSTRUCTION CONTRACTOR SHALL BE SOLELY RESPONSIBLE FOR ALL ASPECTS OF WORK RELATED TO EXCAVATION.
7. ALL CONCRETE USED IN ANY ROADWAY SHALL BE IN COMPLIANCE WITH THE SPECIFIED CLASSES OF CONCRETE IN THE STANDARD SPECIFICATIONS "B" PORTLAND CEMENT CONCRETE PAVEMENT" AND "4.5" QUALITY OF CONCRETE" AS AMENDED BY THE ADDENDUM TO THE NORTH CENTRAL TEXAS STANDARD SPECIFICATIONS FOR PUBLIC WORKS CONSTRUCTION - 2004. ALL OTHER CONCRETE SHALL BE CLASS A CONCRETE.
8. ALL REINFORCING STEEL AND DOWEL BARS IN PAVEMENT SHALL BE SUPPORTED AND MAINTAINED AT THE CORRECT CLEARANCES BY THE USE OF BAR CHAINS OR OTHER APPROVED SUPPORT.
9. ALL CONDUIT MUST BE PLACED WITH A MINIMUM 42" OF COVER, UNLESS OTHERWISE SPECIFIED.
10. ALL BACKFILL WILL BE MECHANICALLY TAMPED IN LIFTS TO A DENSITY OF 90% PROCTOR. THE REQUIRED DENSITY WILL BE OBTAINED BY USING TAMPERS, RAMMERS OR ROLLING EQUIPMENT. LIFTS MAY VARY ACCORDING TO THE TYPE OF EQUIPMENT USED TO OBTAIN THE REQUIRED DENSITY. SAND AND DEBRIS FREE MATERIAL WILL BE USED FOR BACKFILL.



**Legend**

- Aerial Cable
- Down Guy
- Pedestal
- Underground

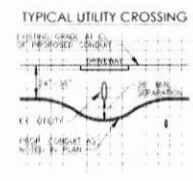

UNDERGROUND CONDUIT 1-2" HDPE

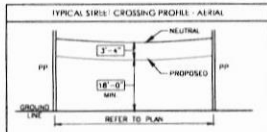

PREPARED BY: DFW TELECOM, INC



Hopkins County

NOTE  
CONTRACTOR IS RESPONSIBLE TO MAINTAIN TRAFFIC CONTROL DEVICES FOR STREETS AND HIGHWAYS

Hopkins County Notes: Bore only no trenching and the conduit placement should be the backside of ditch away from the county road when running parallel to the CR

Project consist of approximately 5,256' underground

GENERAL CONSTRUCTION NOTES

1. ALL CONSTRUCTION WORK WITHIN THE PUBLIC RIGHT-OF-WAY SHALL BE DONE IN ACCORDANCE WITH THE ORDINANCES AND REGULATIONS OF THE MUNICIPALITY IN WHICH THE WORK IS TO BE PERFORMED.
2. EXISTING UTILITY LOCATIONS SHOWN ARE TAKEN FROM AVAILABLE RECORDS AND MAY NOT BE ALL INCLUDING LOCATIONS OF EACH PARTICULAR UTILITY. THE CONSTRUCTION CONTRACTOR SHALL ASSUME RESPONSIBILITY FOR THE LOCATION OF ALL UTILITIES. THE CONSTRUCTION CONTRACTOR SHALL ALSO ASSUME RESPONSIBILITY FOR ANY DAMAGE OR INJURY TO EXISTING UTILITIES AS A RESULT OF THE CONSTRUCTION ACTIVITIES WHETHER THE FACILITY IS SHOWN ON THE DRAWINGS OR NOT.
3. THE CONSTRUCTION CONTRACTOR SHALL BE RESPONSIBLE FOR CONTACTING ALL DEPARTMENTS WITHIN THE MUNICIPALITY AND THE UTILITY COMPANIES AT LEAST TWO WORKING DAYS PRIOR TO THE COMMENCEMENT OF WORK.  
CALL BEFORE YOU DIG  
811  
IT'S THE LAW
4. THE CONTRACTOR SHALL BE RESPONSIBLE FOR THE PROTECTION OF ALL EXISTING UTILITIES AND PUBLIC PROPERTY. IN ADDITION, ALL DAMAGES SUSTAINED BY THE CONSTRUCTION TO EXISTING UTILITIES OR PUBLIC PROPERTY SHALL BE REPAIRED BY THE CONTRACTOR TO ORIGINAL OR BETTER CONDITION.
5. BARRICADING AND TRAFFIC CONTROL SHALL BE THE RESPONSIBILITY OF THE CONSTRUCTION CONTRACTOR AND SHALL CONFORM TO THE TEXAS MANUAL ON UNIFORM TRAFFIC CONTROL DEVICES' TRAFFIC FLOW AND ACCESS FOR PROHIBITING TRAFFIC SAFETY MEASURES FOR WORK ON THE PROJECT THE WORK SITE SHALL BE SUITABLY LIGHTED AND BARRICADED AT NIGHT.
6. THE CONSTRUCTION CONTRACTOR SHALL ABIDE BY ALL APPLICABLE FEDERAL, STATE AND LOCAL LAWS GOVERNING ALL ASPECTS OF EXCAVATION. THE CONSTRUCTION CONTRACTOR SHALL BE SOLELY RESPONSIBLE FOR ALL ASPECTS OF WORK RELATED TO EXCAVATION.
7. ALL CONCRETE USED IN ANY ROADWAY SHALL BE IN COMPLIANCE WITH THE SPECIFIED CLASS OF CONCRETE IN THE SPECIFICATIONS. ALL CONCRETE SHALL BE PLACED WITHIN THE SPECIFIED CLASS OF CONCRETE AS AUTHORIZED BY THE ARCHITECT OR THE NORTH CENTRAL TEXAS STANDARD SPECIFICATIONS FOR PUBLIC WORKS.
8. ALL REINFORCING STEEL AND SOME LIMBS IN PAVEMENT SHALL BE SUPPLIED AND MAINTAINED AT THE CORRECT CLEARANCES BY THE USE OF BARE CHAIRS OR OTHER APPROVED SUPPORT.
9. ALL CONDUIT MUST BE PLACED WITH A MINIMUM 4" OF COVER, UNLESS OTHERWISE SPECIFIED.
10. ALL BACKFILLING WILL BE MECHANICALLY TAMPED IN LIFTS TO A DENSITY OF 95% PRIOR TO THE REQUIRED FINISH SURFACE. THE TYPE OF EQUIPMENT USED TO OBTAIN THE REQUIRED DENSITY, SAND AND TERMS FINE MATERIAL, WILL BE USED FOR BACKFILL.

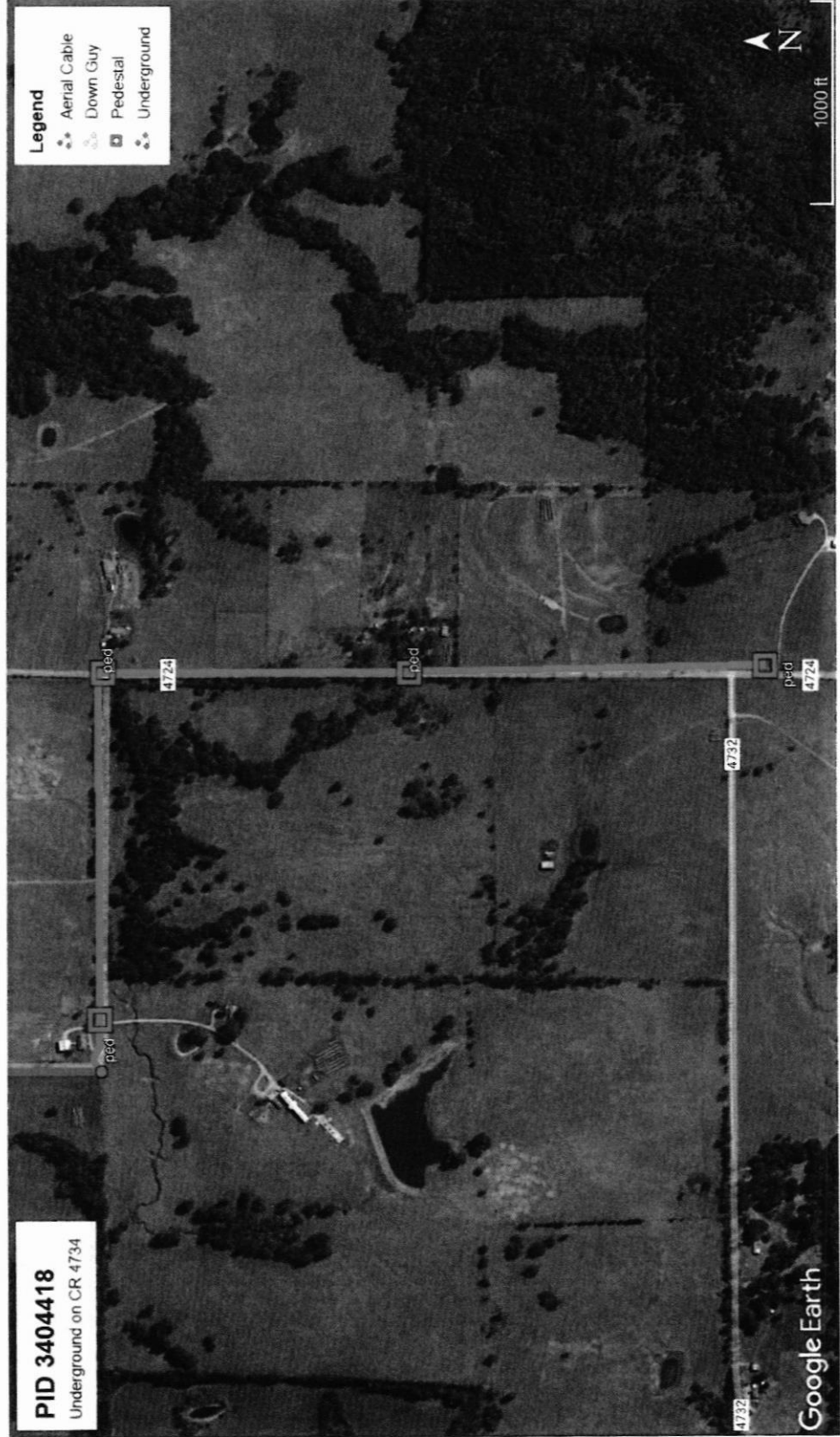

PID 3404418  
Underground on CR 4734

Google Earth

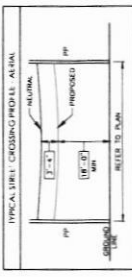
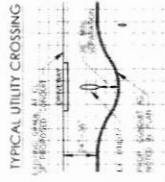

PREPARED BY: DFW TELECOM, INC.



1565 Chenault Street, Dallas, Texas 75228

July 29, 2022

Office of Hopkins County Judge  
PO BOX 288  
Sulphur Springs, Texas 75483

**Underground Parallel &/OR Crossing(s)  
Project PID 3404418**

Greetings,

Spectrum/Charter is requesting permission to construct and placement of underground conduit and fiber. This request is for proposed construction county road 4784, which is located in Hopkins County, Texas.

Site location map and google plans are enclosed. The construction plans detail the proposed work.

If you have any questions, please contact me at any time.

Sincerely,

*Jason Kennedy*

Project Coordinator  
[Jason.kennedy@charter.com](mailto:Jason.kennedy@charter.com)  
Phone 903-513-2738

Submitted by:

Dayna LaPoma / Jessie Hatley  
Project Coordinator / RDOF Coordinator  
[Dayna.lapoma@dfw-telecom.com](mailto:Dayna.lapoma@dfw-telecom.com)  
[Jessie.hatley@dfw-telecom.com](mailto:Jessie.hatley@dfw-telecom.com)

Enclosures

---

County Approval Section:

Approved: \_\_\_\_\_

Denied: \_\_\_\_\_

Authorized Signature: \_\_\_\_\_

Date: \_\_\_\_\_

*8-8-22*



Hopkins County

CONTRACTOR IS RESPONSIBLE FOR MAINTAINING TRAFFIC CONTROL DEVICES AS SET FORTH IN THE TEXAS MANUAL ON UNIFORM TRAFFIC CONTROL DEVICES FOR STREETS AND HIGHWAYS

Hopkins County Notes: Bore only no trenching and the conduit placement should be the backside of ditch away from the county road when running parallel to the CR

Project consist of approximately: 421' underground

GENERAL CONSTRUCTION NOTES

1. ALL CONSTRUCTION WORK WITHIN THE PUBLIC RIGHT-OF-WAY SHALL BE DONE IN ACCORDANCE WITH THE ORDINANCES AND REGULATIONS OF THE MUNICIPALITY IN WHICH THE WORK IS TO BE PERFORMED.
2. THE CONTRACTOR SHALL BE RESPONSIBLE FOR OBTAINING ALL NECESSARY PERMITS AND APPROVALS FROM ALL APPLICABLE AGENCIES AND AGENCIES INVOLVED IN THE PROJECT. THE CONTRACTOR SHALL BE RESPONSIBLE FOR OBTAINING ALL NECESSARY PERMITS AND APPROVALS FROM ALL APPLICABLE AGENCIES AND AGENCIES INVOLVED IN THE PROJECT. THE CONTRACTOR SHALL BE RESPONSIBLE FOR OBTAINING ALL NECESSARY PERMITS AND APPROVALS FROM ALL APPLICABLE AGENCIES AND AGENCIES INVOLVED IN THE PROJECT.
3. THE CONTRACTOR SHALL BE RESPONSIBLE FOR CONTACTING ALL DEPARTMENTS WITHIN THE MUNICIPALITY AND THE UTILITY COMPANIES AT LEAST TWO WORKING DAYS PRIOR TO THE COMMENCEMENT OF WORK.
4. IT SHALL BE THE RESPONSIBILITY OF THE CONSTRUCTION CONTRACTOR TO: A) PRESENT DAMAGE TO PRIVATE AND PUBLIC PROPERTY; B) RESTORE ALL AREAS EFFECTED BY THE CONSTRUCTION TO ORIGINAL OR BETTER CONDITION.
5. BARRICADE AND TRAFFIC CONTROL SHALL BE THE RESPONSIBILITY OF THE CONSTRUCTION CONTRACTOR AND SHALL BE MAINTAINED THROUGHOUT THE PROJECT. THE CONTRACTOR SHALL BE RESPONSIBLE FOR MAINTAINING TRAFFIC CONTROL DEVICES THROUGHOUT THE PROJECT. THE CONTRACTOR SHALL BE RESPONSIBLE FOR MAINTAINING TRAFFIC CONTROL DEVICES THROUGHOUT THE PROJECT.
6. THE CONTRACTOR SHALL BE RESPONSIBLE FOR OBTAINING ALL NECESSARY PERMITS AND APPROVALS FROM ALL APPLICABLE AGENCIES AND AGENCIES INVOLVED IN THE PROJECT. THE CONTRACTOR SHALL BE RESPONSIBLE FOR OBTAINING ALL NECESSARY PERMITS AND APPROVALS FROM ALL APPLICABLE AGENCIES AND AGENCIES INVOLVED IN THE PROJECT.
7. THE CONTRACTOR SHALL BE RESPONSIBLE FOR OBTAINING ALL NECESSARY PERMITS AND APPROVALS FROM ALL APPLICABLE AGENCIES AND AGENCIES INVOLVED IN THE PROJECT. THE CONTRACTOR SHALL BE RESPONSIBLE FOR OBTAINING ALL NECESSARY PERMITS AND APPROVALS FROM ALL APPLICABLE AGENCIES AND AGENCIES INVOLVED IN THE PROJECT.
8. THE CONTRACTOR SHALL BE RESPONSIBLE FOR OBTAINING ALL NECESSARY PERMITS AND APPROVALS FROM ALL APPLICABLE AGENCIES AND AGENCIES INVOLVED IN THE PROJECT. THE CONTRACTOR SHALL BE RESPONSIBLE FOR OBTAINING ALL NECESSARY PERMITS AND APPROVALS FROM ALL APPLICABLE AGENCIES AND AGENCIES INVOLVED IN THE PROJECT.
9. ALL CONDUIT MUST BE PLACED WITH A MINIMUM 42" OF COVER UNLESS OTHERWISE SPECIFIED.
10. ALL CONDUIT MUST BE PLACED WITH A MINIMUM 42" OF COVER UNLESS OTHERWISE SPECIFIED.

PID 3404418  
Underground on CR 4784

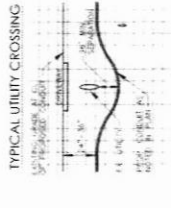

UNDERGROUND CONDUIT 1-2" HOPE

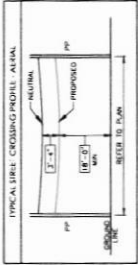



1565 Chenault Street, Dallas, Texas 75228

July 29, 2022

Office of Hopkins County Judge  
PO BOX 288  
Sulphur Springs, Texas 75483

**Underground Parallel &/OR Crossing(s)  
Project PID 3404418**

Greetings,

Spectrum/Charter is requesting permission to construct and placement of underground conduit and fiber. This request is for proposed construction county road 4792, which is located in Hopkins County, Texas.

Site location map and google plans are enclosed. The construction plans detail the proposed work.

If you have any questions, please contact me at any time.

Sincerely,

*Jason Kennedy*

Project Coordinator  
[Jason.kennedy@charter.com](mailto:Jason.kennedy@charter.com)  
Phone 903-513-2738

Submitted by:

Dayna LaPoma / Jessie Hatley  
Project Coordinator / RDOF Coordinator  
[Dayna.lapoma@dfw-telecom.com](mailto:Dayna.lapoma@dfw-telecom.com)  
[Jessie.hatley@dfw-telecom.com](mailto:Jessie.hatley@dfw-telecom.com)

Enclosures

---

County Approval Section:

Approved: \_\_\_\_\_ Denied: \_\_\_\_\_  
Authorized Signature:  \_\_\_\_\_ Date: 8-8-22



Hopkins County

NOTE:  
CONTRACTOR IS RESPONSIBLE TO MAINTAIN TRAFFIC CONTROL DEVICES AS SET FORTH IN THE TEXAS MANUAL ON UNIFORM TRAFFIC CONTROL DEVICES FOR STREETS AND HIGHWAYS

Hopkins County Notes: Bare only no trenching and the conduit placement should be the backside of ditch away from the county road when running parallel to the CR

Project consist of approximately:  
330' underground

PID 3404418

Underground on CR 4792

GENERAL CONSTRUCTION NOTES

1. ALL CONSTRUCTION WORK WITHIN THE PUBLIC RIGHT OF WAY SHALL BE DONE IN ACCORDANCE WITH THE ORDINANCES AND REGULATIONS OF THE MUNICIPALITY IN WHICH THE WORK IS TO BE PERFORMED.
2. EXISTING UTILITY LOCATIONS SHOWN ARE TAKEN FROM AVAILABLE RECORDS AND MAY NOT BE ALL INCLUDING ALL UTILITIES. THE CONSTRUCTION CONTRACTOR SHALL ASSUME RESPONSIBILITY FOR VERIFYING THE LOCATION OF ALL UTILITIES. THE CONSTRUCTION CONTRACTOR SHALL BE RESPONSIBLE FOR NOTIFYING ALL UTILITIES AND OBTAINING NECESSARY APPROVALS. THE CONTRACTOR SHALL BE RESPONSIBLE FOR DAMAGING AS A DIRECT RESULT OF THE CONSTRUCTION ACTIVITIES WHETHER THE FACILITY IS SHOWN ON THE RECORDS OR NOT.
3. THE CONSTRUCTION CONTRACTOR SHALL BE RESPONSIBLE FOR CONTACTING ALL DEPARTMENTS WITHIN THE MUNICIPALITY AND THE UTILITY COMPANIES AT LEAST TWO WORKING DAYS PRIOR TO THE COMMENCEMENT OF WORK.  
CALL BEFORE YOU DIG  
811  
IT'S THE LAW
4. IT SHALL BE THE RESPONSIBILITY OF THE CONSTRUCTION CONTRACTOR TO: A) PREVENT DAMAGE TO PRIVATE AND PUBLIC PROPERTY; B) INSURE ALL AREAS EFFECTED BY THE CONSTRUCTION TO REMAIN IN BETTER CONDITION THAN BEFORE THE CONSTRUCTION.
5. BARRICADING AND TRAFFIC CONTROL SHALL BE THE RESPONSIBILITY OF THE CONSTRUCTION CONTRACTOR AND SHALL CONFORM TO THE TEXAS MANUAL ON UNIFORM TRAFFIC CONTROL DEVICES. TRAFFIC FLOW AND ACCESS TO THE PROJECT SHALL BE MAINTAINED AT ALL TIMES. THE CONSTRUCTION CONTRACTOR SHALL BE RESPONSIBLE FOR PROVIDING TRAFFIC SAFETY MEASURES FOR WORK ON THE PROJECT. THE WORK SITE SHALL BE SUITABLY LIT AND BARRICADED AT NIGHT.
6. THE CONSTRUCTION CONTRACTOR SHALL ABIDE BY ALL APPLICABLE FEDERAL, STATE AND LOCAL LAWS GOVERNING THE CONSTRUCTION OF UNDERGROUND FACILITIES. THE CONSTRUCTION CONTRACTOR SHALL BE SOLELY RESPONSIBLE FOR ALL ASPECTS OF WORK RELATED TO EXCAVATION.
7. ALL CONCRETE USED IN ANY ROADWAY SHALL BE IN COMPLIANCE WITH THE SPECIFIED CLASSES OF CONCRETE IN THE TEXAS MANUAL ON UNIFORM TRAFFIC CONTROL DEVICES. ALL CONCRETE SHALL BE CLASS A CONCRETE. ALL REINFORCING STEEL AND DOWEL BARS IN PAVEMENT SHALL BE SUPPORTED AND MAINTAINED AT THE CORRECT CLEARANCES BY THE USE OF BAR CHAIRS OR OTHER APPROVED SUPPORT.
8. ALL CONCRETE MUST BE PLACED WITH A MINIMUM 4" OF COVER, UNLESS OTHERWISE SPECIFIED.
9. ALL REINFORCING STEEL AND DOWEL BARS IN PAVEMENT SHALL BE SUPPORTED AND MAINTAINED AT THE CORRECT CLEARANCES BY THE USE OF BAR CHAIRS OR OTHER APPROVED SUPPORT.
10. ALL REINFORCING STEEL AND DOWEL BARS IN PAVEMENT SHALL BE SUPPORTED AND MAINTAINED AT THE CORRECT CLEARANCES BY THE USE OF BAR CHAIRS OR OTHER APPROVED SUPPORT.
11. ALL REINFORCING STEEL AND DOWEL BARS IN PAVEMENT SHALL BE SUPPORTED AND MAINTAINED AT THE CORRECT CLEARANCES BY THE USE OF BAR CHAIRS OR OTHER APPROVED SUPPORT.
12. ALL REINFORCING STEEL AND DOWEL BARS IN PAVEMENT SHALL BE SUPPORTED AND MAINTAINED AT THE CORRECT CLEARANCES BY THE USE OF BAR CHAIRS OR OTHER APPROVED SUPPORT.
13. ALL REINFORCING STEEL AND DOWEL BARS IN PAVEMENT SHALL BE SUPPORTED AND MAINTAINED AT THE CORRECT CLEARANCES BY THE USE OF BAR CHAIRS OR OTHER APPROVED SUPPORT.
14. ALL REINFORCING STEEL AND DOWEL BARS IN PAVEMENT SHALL BE SUPPORTED AND MAINTAINED AT THE CORRECT CLEARANCES BY THE USE OF BAR CHAIRS OR OTHER APPROVED SUPPORT.
15. ALL REINFORCING STEEL AND DOWEL BARS IN PAVEMENT SHALL BE SUPPORTED AND MAINTAINED AT THE CORRECT CLEARANCES BY THE USE OF BAR CHAIRS OR OTHER APPROVED SUPPORT.
16. ALL REINFORCING STEEL AND DOWEL BARS IN PAVEMENT SHALL BE SUPPORTED AND MAINTAINED AT THE CORRECT CLEARANCES BY THE USE OF BAR CHAIRS OR OTHER APPROVED SUPPORT.
17. ALL REINFORCING STEEL AND DOWEL BARS IN PAVEMENT SHALL BE SUPPORTED AND MAINTAINED AT THE CORRECT CLEARANCES BY THE USE OF BAR CHAIRS OR OTHER APPROVED SUPPORT.
18. ALL REINFORCING STEEL AND DOWEL BARS IN PAVEMENT SHALL BE SUPPORTED AND MAINTAINED AT THE CORRECT CLEARANCES BY THE USE OF BAR CHAIRS OR OTHER APPROVED SUPPORT.
19. ALL REINFORCING STEEL AND DOWEL BARS IN PAVEMENT SHALL BE SUPPORTED AND MAINTAINED AT THE CORRECT CLEARANCES BY THE USE OF BAR CHAIRS OR OTHER APPROVED SUPPORT.
20. ALL REINFORCING STEEL AND DOWEL BARS IN PAVEMENT SHALL BE SUPPORTED AND MAINTAINED AT THE CORRECT CLEARANCES BY THE USE OF BAR CHAIRS OR OTHER APPROVED SUPPORT.

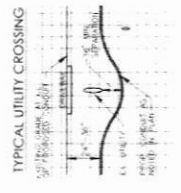

UNDERGROUND CONDUIT 12" HDPE

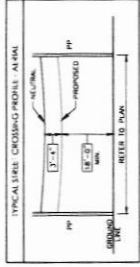

PREPARED BY: DFW TELECOM, INC

